

TYPE
BTU

Thread	Dia. (mm)	Rework service	Use
Outer	12.60 - 15.59	Retipping	First recommendation in brazed drills

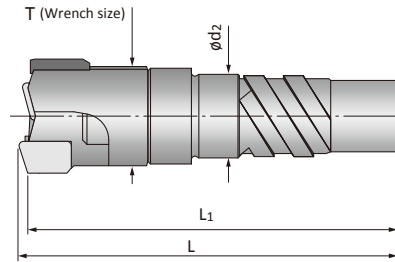
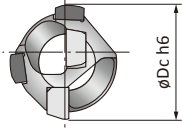

Tolerance: IT9
Surface roughness: Ra 2 μ m

Best suited carbide combination

Best grade available for each workpiece material

Good chip evacuation

Best tip geometry to ensure good chip control and efficient chip exhaust

Cost efficient retipping service

Retipping of used carbide tips and guide pads and re-coating available

Product description chart

Dia. Dc (mm) Tolerance h6	Drill head main code	Drill tube		Dimensions (mm)			
		Code	Dia.(mm)	L	L ₁	d ₂	T
12.60 - 13.10	BTU-00941	ST0094	11	43	41.9	9.6	10
13.11 - 13.60	BTU-00942	ST0094	11	43	41.9	9.6	10
13.61 - 14.10	BTU-00951	ST0095	12	43	41.8	10.6	11
14.11 - 14.60	BTU-00952	ST0095	12	43	41.8	10.6	11
14.61 - 15.10	BTU-00961	ST0096	13	43	41.7	11.6	12
15.11 - 15.59	BTU-00962	ST0096	13	43	41.7	11.6	12

Grade

See page 9 for grade selection chart

Grade	(Previous Grade)	ISO area							
		5	10	15	20	25	30	35	40
P	1122 (UP ZAP)								
M	2122 (N3 ZAP)								
K	1122 (UP ZAP)								
N	1122 (UP ZAP)								
S	1122 (UP ZAP)								

• A drill head without coating also available upon request. Please contact us for more detail.

Ordering example

BTU - -

Drill head main code Diameter (mm) Grade

Ordering example : BTU-00961 15.00-1122 20 pcs

- ⚠ Be sure to use a wrench to tighten drill properly to bar.
- For your safety, do not touch the tool or the workpiece when in operation.

BTU type Drill Head (3 tip type)

First recommendation for $\phi 15.60 - 65.00$ (mm)

TYPE BTU

Thread	Dia. (mm)	Rework service	Use
Outer	15.60 - 65.00	Retipping	First recommendation in brazed drills

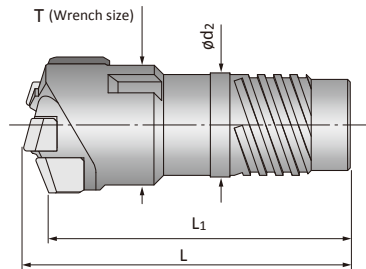
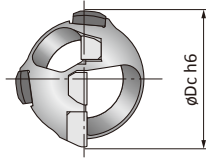

Tolerance: IT9
Surface roughness: Ra 2 μ m

Best suited carbide combination
Best grade available for each workpiece material

Good chip evacuation
Best tip geometry to ensure good chip control and efficient chip exhaust

Cost efficient retipping service
Retipping of used carbide tips and guide pads and re-coating available

Product description chart

Dia. Dc (mm) Tolerance h6	Drill head main code	Drill tube		Dimensions (mm)			
		Code	Dia.(mm)	L	L ₁	d ₂	T
15.60 - 16.20	BTU-00971	ST0097	14	43	40.3	12.6	-
16.21 - 16.70	BTU-00972	ST0097	14	43	40.3	12.6	14
16.71 - 17.20	BTU-00981	ST0098	15	43	40.3	13.6	15
17.21 - 17.70	BTU-00982	ST0098	15	43	40.3	13.6	15
17.71 - 18.40	BTU-00991	ST0099	16	47	44.2	14.5	15
18.41 - 18.90	BTU-00992	ST0099	16	47	44.1	14.5	-
18.91 - 19.20	BTU-001	ST0000	17	47	44.1	15.5	17
19.21 - 20.00	BTU-002	ST0000	17	47	44	15.5	18
20.01 - 20.90	BTU-011	ST00	18	52.5	49.4	16	18
20.91 - 21.80	BTU-012	ST00	18	52.5	49.4	16	19
21.81 - 22.90	BTU-021	ST01	20	56	52.8	18	20
22.91 - 24.10	BTU-022	ST01	20	56	52.6	18	21
24.11 - 25.20	BTU-031	ST02	22	57.5	54	19.5	23
25.21 - 26.40	BTU-032	ST02	22	57.5	54	19.5	24
26.41 - 27.50	BTU-041	ST03	24	57.5	53.8	21	25
27.51 - 28.70	BTU-042	ST03	24	57.5	53.8	21	26
28.71 - 29.80	BTU-051	ST04	26	63.5	59.5	23.5	27
29.81 - 31.00	BTU-052	ST04	26	63.5	59.3	23.5	28
31.01 - 32.10	BTU-061	ST05	28	63.5	59.4	25.5	29
32.11 - 33.30	BTU-062	ST05	28	63.5	59.1	25.5	30
33.31 - 34.80	BTU-071	ST06	30	63.5	59	28	32
34.81 - 36.20	BTU-072	ST06	30	63.5	58.9	28	33
36.21 - 37.30	BTU-081	ST07	33	73.5	68.7	30	34
37.31 - 38.40	BTU-082	ST07	33	73.5	68.5	30	35
38.41 - 39.60	BTU-083	ST07	33	73.5	68.3	30	36
39.61 - 40.60	BTU-091	ST08	36	73.5	68.2	33	37
40.61 - 41.80	BTU-092	ST08	36	73.5	68	33	38
41.81 - 43.00	BTU-093	ST08	36	73.5	67.8	33	39
43.01 - 44.30	BTU-101	ST09	39	75	69.5	36	41
44.31 - 45.60	BTU-102	ST09	39	75	69.3	36	42
45.61 - 47.00	BTU-103	ST09	39	75	69.1	36	43
47.01 - 48.50	BTU-111	ST10	43	75	68.8	39	44
48.51 - 50.10	BTU-112	ST10	43	75	68.7	39	46
50.11 - 51.70	BTU-113	ST10	43	75	68.5	39	47
51.71 - 53.20	BTU-121	ST11	47	82	75.2	43	49
53.21 - 54.70	BTU-122	ST11	47	82	75.2	43	50
54.71 - 56.20	BTU-123	ST11	47	82	75.2	43	51
56.21 - 58.40	BTU-131	ST12	51	84	77.4	47	54
58.41 - 60.60	BTU-132	ST12	51	84	76.9	47	55
60.61 - 62.80	BTU-133	ST12	51	84	76.8	47	57
62.81 - 65.00	BTU-134	ST12	51	84	76.5	47	59
60.61 - 62.80	BTU-133L	ST13	56	84	76.8	51	57
62.81 - 65.00	BTU-134L	ST13	56	84	76.5	51	59

Grade

See page 9 for grade selection chart

Grade	(Previous Grade)	ISO area								
		5	10	15	20	25	30	35	40	
P	1122 (UP ZAP)									
	1132 (UX-2 ZAP)									
M	1132 (UX-2 ZAP)									
	2122 (N3 ZAP)									
K	3132 (TFKS ZAP)									
	3132 (TFKS ZAP)									
S	3132 (TFKS ZAP)									
	3132 (TFKS ZAP)									

• A drill head without coating also available upon request. Please contact us for more detail.

Ordering example

BTU - -

Drill head main code Diameter (mm) Grade

Ordering example 1 : BTU-052 30.00-1132 20 pcs
Ordering example 2 : BTU-133L 62.50-1132 10 pcs

⚠ Be sure to use a wrench to tighten drill properly to bar.
• For your safety, do not touch the tool or the workpiece when in operation.